



Assembly Instructions Folio Box Option for Rehearsal Resource Center

Basic Instructions only!
For more detailed product information, refer to the
Rehearsal Resource Center Assembly Instructions 121B021.

CAUTION
Make sure anyone assembling, installing or using this product has read and understands these instructions.

CAUTION
Failure to comply with Warnings and Cautions in this document or on the equipment can result in damage to property or injury.

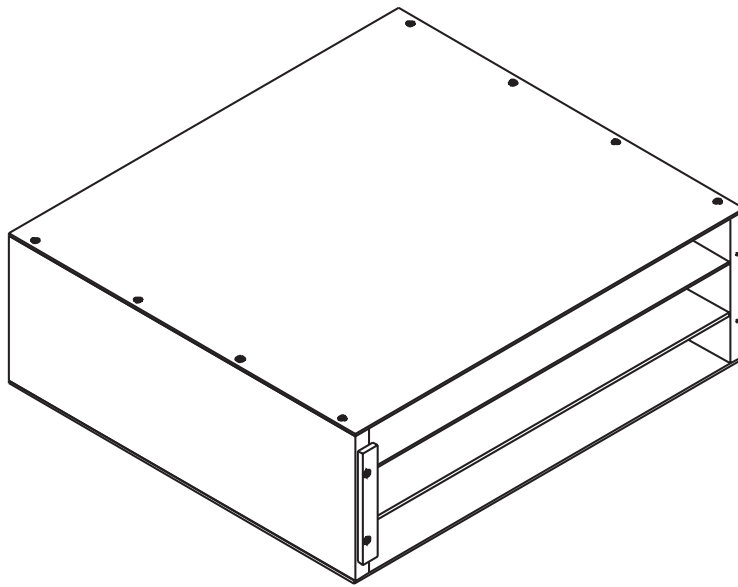

Contents

Required Tools	2	Parts List	2
Supplied Hardware	2	Assembly	2



Visit the Rehearsal Resource Center web page at wengercorp.com for more information.

Note: Please read and understand these instructions before proceeding.
Note: If you need additional information, contact Wenger Corporation using the information below.

Required Tools

The use of a power driver is not recommended.

- Phillips screwdriver

Supplied Hardware

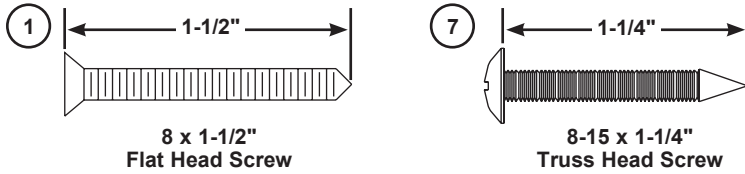

Parts List

Item	Description	Item	Description
1	8-18 x 1-1/2" Flat Head Screw	5	Folio Box Shelf
2	Tapered Square Plastic Bumper	6	Folio Box Shelf Support
3	Backstop Folio Box	7	8-15 x 1-1/4 Truss Head Screw
4	Flat Panel Folio Box		

Assembly

Before starting the folio box option assembly, do the following.

1. Read and understand this assembly instruction.
2. Remove all items from the shipping cartons. Make sure that all parts are present. Item numbers refer to the parts list.
3. Inventory the hardware package and make sure that all required hardware is present. Discard any items not used during the assembly.

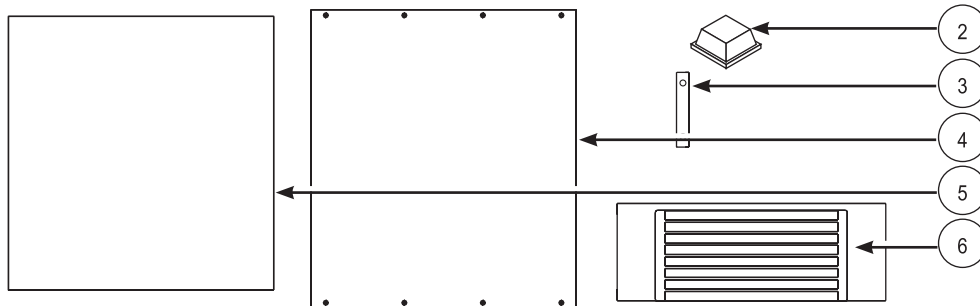

Assembly (continued)

To assemble a folio box, do as follows.

1. Attach the folio box backstop (3) to one folio box shelf support (6) with two truss head screws (7). Pilot holes on the end of the side panel locate the position of the backstop.
2. Align the clearance holes in two folio box flat panels (4) with the pilot holes in two folio box shelf supports (6). Make sure that the shelf support slots face the inside of the box.
3. Using a phillips screwdriver, fasten the flat panels (4) to the shelf supports (6) by screwing sixteen flat head screws (1) into the clearance holes.
4. Insert two folio box shelves (5) into the slots in the shelf supports (6).

NOTICE

Spacing the shelves with three empty slots between each shelf allows 2" (51 mm) between shelves.

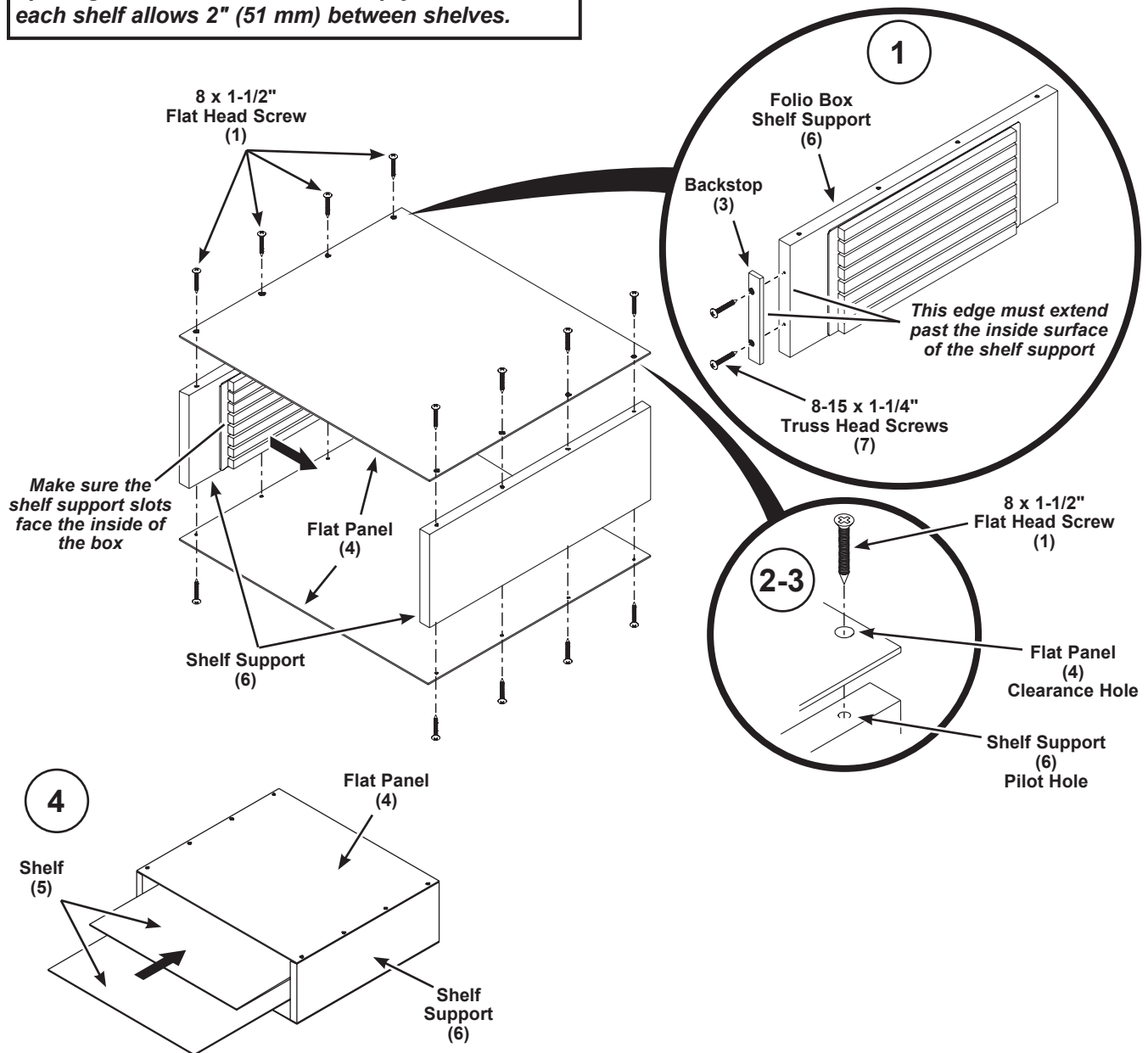

Assembly (continued)

5. Install the folio boxes in a unit assembly as follows:
 - a. Remove the protective backing on a bumper (2) and place the bumper (2), with the adhesive side against the mid-shelf surface, directly below the pass through door lock at the back of the unit assembly mid-shelf as shown below.
 - b. Place the folio box assemblies on the mid-shelf with a side of the right folio box against the right side panel of the left curved unit assembly (left side for the right curved unit assembly).
 - c. Remove the protective backing from two bumpers (2) and place the bumpers (2), with the adhesive side against the mid-shelf surface, so that the edge of the bumpers is against the left side of the left folio box (right side for the right curved unit assembly) as shown in the illustration below.
 - d. Remove the protective backing from a bumper (2) and place the bumper (2), with the adhesive side against the mid-shelf surface, at the front of the folio boxes at a point where their sides touch as shown in the illustration below.

*Left curved unit assembly shown with the top panel removed for clarity.
Do not actually remove the top panel!*

